

Check the condition of the drive belt. Examine the edges of belt for cracks or fraying.

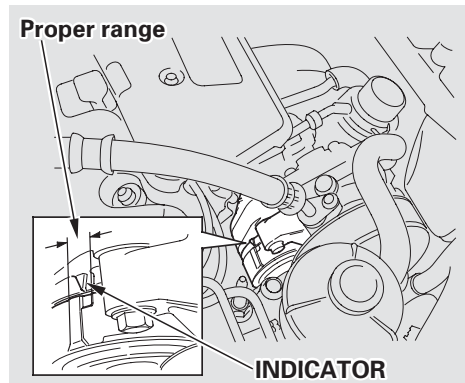

An auto-tensioner adjusts the tension of the drive belt. The pointer on the auto-tensioner should be in the proper range. It should be checked according to the time and distance recommendations in the maintenance schedule.

If the pointer is not within the proper range or you see signs of wear, have the drive belt replaced by your Honda dealer as soon as possible.